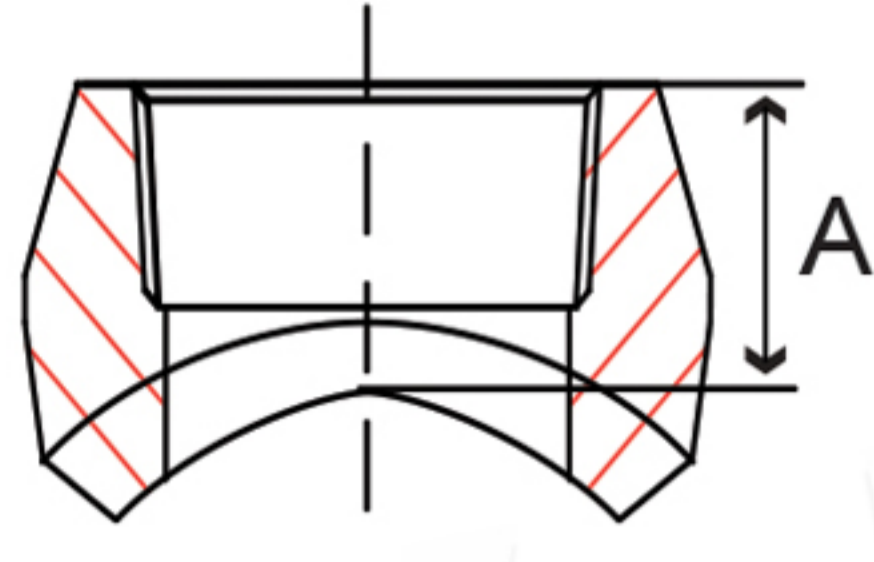

Fig. 43T03 – Threaded Outlet



Size IN	Part Number	A IN	Master	Weight LB
1/4 x 3/8 thru 36	43TO3002003360	0.75	200	.02
1/2 x 3/4 thru 36	43TO3004006360	1.00	150	0.2
3/4 x 1 thru 1-1/4	43TO3006010012	1.06	100	0.2
3/4 x 1-1/2 thru 36	43TO3006014360	1.06	100	0.2
1 x 1-1/4 thru 2-1/2	43TO3010012024	1.31	50	0.5
1 x 3 thru 36	43TO3010030360	1.31	50	0.5
1-1/4 x 1-1/2	43TO3012010004	1.31	40	0.8
1-1/4 x 2 thru 3-1/2	43TO3012020034	1.31	40	0.8
1-1/4 x 4 thru 36	43TO3012040360	1.31	40	0.8
1-1/2 x 2 thru 2-1/2	43TO3014020024	1.38	25	1.0
1-1/2 x 3 thru 5	43TO3014030050	1.38	25	1.0
1-1/2 x 6 thru 36	43TO3014060360	1.38	25	1.0
2 x 2-1/2 thru 3-1/2	43TO3020024034	1.50	10	1.7
2 x 4 thru 6	43TO3020040060	1.50	15	1.7
2 x 8 thru 36	43TO3020080360	1.50	15	1.7
2-1/2 x 3 thru 3-1/2	43TO3024030034	1.81	10	2.5
2-1/2 x 4 thru 5	43TO3024040050	1.81	10	2.5
2-1/2 x 6 thru 8	43TO3024060080	1.81	10	2.5
2-1/2 x 10 thru 36	43TO3024100360	1.81	10	2.5
3 x 3-1/2 thru 4	43TO3030034040	2.00	6	4.0
3 x 5 thru 6	43TO3030050060	2.00	6	4.0
3 x 8 thru 14	43TO3030080140	2.00	6	4.0
3 x 16 thru 36	43TO3030160360	2.00	6	4.0
4 x 5 thru 6	43TO3040050060	2.25	3	6.3
4 x 8 thru 10	43TO3040080100	2.25	3	6.3
4 x 12 thru 20	43TO3040120200	2.25	3	6.3
4 x 22 thru 36	43TO3040220360	2.25	3	6.3